

DM SERIES



MP-DM01-6401-US3



MP-DM02-6401-US5



MP-DM03-6401-US15



MP-DM05-6401-US3



MP-DM04-6401-US3

美式重型插芯門鎖

HEAVY DUTY US MORTISE LOCK

DA SERIES



MP-DA01-6401-US3



MP-DA01-6401-US3



MP-DA02-6401-US5



MP-DA03-6401-US15



MP-DA06-6401-US3



MP-DA04-6401-US3

DB SERIES



MP-DB01-6401-US3



MP-DB02-6401-US5



MP-DB03-6401-US3



MP-DB04-6401-US5



MP-DB06-6401-US3

DF SERIES



MP-DF04-6401-US15



MP-DF06-6401-US5



MP-DF01-6401-US3



MP-DF02-6401-US15



MP-DF03-6401-US3

HEAVY DUTY US MORTISE LOCK

美式重型插芯門鎖

The "Marco Polo" heavy duty US mortise lock provides the highest level of security and is the ideal standard of residential heavy duty quality. All locks are designed as

馬可勃羅重型插芯門鎖具備高保安及質量等優點，是理想的高級保安住宅用門鎖；所有鎖類被設計為：

- Major interior working parts are made of solid forged brass or stainless steel.
主要的內部配件均採用鍛銅或不銹鋼原料製造。
- 1" (25mm) Dead bolt throw with two hardened steel rod avoid breaking and sawing.
兩條高硬鋼製造之柱杆藏於一對之輔助鎖內，防折斷、防撬、防鋸。
- Anti-panic operation - Turning inside knob or lever reacts the latch bolt and dead bolt simultaneously, automatically unlocking outside knob or lever.
緊急逃生操控 - 轉動內把手或水平把手時緩衝鎖舌及輔助鎖將同時開啓，門外用匙及轉動把手或水平把手開啓。(靈活方便及安全)
- Provides different spindle for the different thickness of door.
提供不同軸芯適用於不同門厚度的要求
- Under patent of: USA4988133, CANADA:2003262 ROC:51315 & 50685
專利註冊編號：美國4988133、加拿大2003262、中國51315及50685
- UL approval for fire test 3 hours
通過美國聯邦實驗三小時燃燒測試
- Saw resistance
防鋸
- Break resistance
防撬
- Pick resistance
防百合匙
- Dummy trim option for double door
雙門用假手可供選擇

DM SERIES



MP-DM01-6401-US3



MP-DM02-6401-US5

HEAVY DUTY US MORTISE LOCK

2

MARCO
POLO®

美式重型插芯門鎖

Design/設計

- Material: Forged Brass,
材料：鍛銅
- Faceplate: Divided into four different designs of DA, DB, DF, DL and DM.
面板：分為DA, DB, DF, DL及DM 四類不同設計
- Interior Lever Design: K=Oval knob L=Lever H=Handle
內把手：K=橢圓形把手 L=水平把手 H=垂直按抽手
- Backset: 64mm or 70mm and 90mm
孔中：64, 70, 90毫米
- Function: Entrance with emergency egress and Privacy
功能：房門連動鎖及浴室鎖
- Finish available/顏色: US3, US4, US5, US26, US26D, US32, US32D US3/US4, US4/US3, US26/US26D, US32, US32D

DM SERIES



MP-DM03-6401-US15



MP-DM04-6401-US3



MP-DM06-6401-US3

HEAVY DUTY US MORTISE LOCK

3

MARCO
POLO®

美式重型插芯門鎖

US Mortise Lock case / 美式插芯鎖盒

- Emergency panic function
Inside knob or lever can withdraw bolt latch and dead bolt in one action; allowing quick escape for fire and safety reasons, without compromising security, as per "Secure by Design" proposals.
緊急逃生功能
內把手或水平把手在轉動時在同一動作下抽離緩衝鎖舌及輔助鎖，可在最快時間內逃離現場而無需依靠原揸手轉動鎖面轉動把手及水平把手。符合[保安美觀]的主旨。
- Anti-thrust bolt / 反鎖閂
Inhibits the latch from being tampered with when in locked position.
當門被關上，反鎖閂將自動嵌入面閂啓反鎖功能，防硬物撬動緩衝鎖舌。
- Latch Bolt
Reversible design provides convenience of without removing the lock case cover.
緩衝鎖舌
靈活方便的轉變緩衝鎖舌方向設計，無需拆除鎖盒
- Lock case faceplate
Brass plate provides different finishes.
鎖盒面板
鍍銅制面板配備各種不同顏色
- Dead bolt
High quality 1" (25mm) solid brass dead bolt with 2 hardened steel rod throw the dead bolt.
輔助鎖芯
一吋 (25毫米) 實芯鍍銅高質輔助鎖芯藏兩支高硬鋼柱杆
- Lock case
64/70mm lock case with fire panic function and UL 3 hours approval.
鎖盒：64或70毫米具備通過美國聯邦實驗三小時燃燒測試

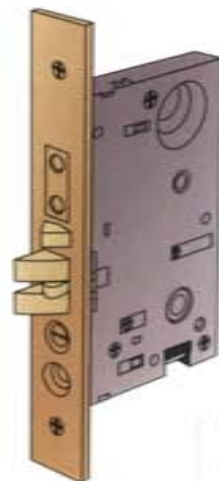

PATENT.

U.S.A.: 4988133

CANADA: 2003262

R.O.C.: 51315 & 50685

DA SERIES



MP-DAB1-6401-US3



MP-DA01-6401-US3



MP-DA02-6401-US5



HEAVY DUTY US MORTISE LOCK

MARCO
POLO®

4

美式重型插芯門鎖

🔑 US Mortise Cylinder / 美式插芯鎖筒

- Anti pick keyway provides security keying differs.
防百合匙電腦匙設計及提供衆多保安匙組
- Traditional keys and dimple keys option
傳統型五珠及電腦匙供選擇
- Dull nickel-plated dimple keys.
鍍線電腦匙

DA SERIES



MP-DA03-6401-US15



MP-DA06-6401-US3



MP-DA04-6401-US3

DB SERIES



MP-DB01-6401-US3



MP-DB03-6401-US3



MP-DB02-6401-US5

HEAVY DUTY US MORTISE LOCK

美式重型插芯門鎖



5

MARCO
POLO®

HOW TO ORDER 如何訂購

DA 03 - 64 01 - US3 - R 1



背板設計
TRIM DESIGN

DA DB DF DL DM

HANDLE DESIGN/把手設計

- 01 (K/K)
- 02 (K/H)
- 03 (L/L)
- 04 (L/H)
- 06 (H/H)

BACKSET/孔中

- 64mm(2 1/2")
- 70mm(2 3/4")
- 90mm(3 1/2")

LOCK FUNCTION/鎖功能

- | | |
|---------------------------------|-------------------------------------|
| 01 ENTRANCE-EMERGENCY EGRESS/大門 | 05C CLASSROOM/課室 |
| 02 HOTEL/MOTEL GUEST-ROOM/酒店客房 | 06 STORE & COMMUNICATING/士多房 |
| 03 CORRIDOR & OFFICE/走廊 | 07 PASSAGE/通道 |
| 04 STOREROOM/士多房 | 08 PRIVACY/浴室 |
| 05 ENTRANCE & STOREROOM/房門及士多房 | 16 DEADLOCK-DOUBLE CYLINDER/輔助鎖-雙鎖筒 |
| 05B DORMITORY/住宅 | 17 DEADLOCK-SINGLE CYLINDER/輔助鎖-單鎖筒 |

CYLINDER/匙筒

- 1: SINGLE CYLINDER/單鎖筒
- 2: DOUBLE CYLINDER/雙鎖筒

DOOR HANDING/門方向

- RH: RIGHT HAND/右手
- LH: LEFT HAND/左手

FINISHES/顏色

- US3: POLISHED BRASS/光金
- US4: STAIN BRASS/沙金
- US5: ANTIQUE BRASS/青古銅
- US26: BRIGHT CHROME/光飾
- US15: STAIN NICKEL/沙銀
- C51: 24K GOLDEN/24K金
- P18: PVD/永不磨損

DB SERIES



*Please specify door thickness when ordering. Standard packing is suitable for D. T. 45mm.

請訂單時提供門厚,標準包裝是為45毫米

HEAVY DUTY US MORTISE LOCK

6



美式重型插芯門鎖

FUNCTION CODE	LOCATION	DIAGRAM INT. EXT.	OPERATION	FUNCTION CODE	LOCATION	DIAGRAM INT. EXT.	OPERATION
01	ENTRANCE -EMERGENCY EGRESS		Latch bolt by knob from either side, except when outside knob is locked by stop in front. Then latch bolt by key outside and knob inside. Dead bolt by key outside and turn piece inside. When dead bolt is thrown, stop it automatically activated making outside knob rigid. Inside knob retracts latch and dead bolt simultaneously but DOES NOT free outside knob.	05C	CLASSROOM		Latch by knob either side except when outside knob is locked by key; then key outside or knob inside. Auxiliary latch deadlocks latch.
01A	ENTRANCE W/O EGRESS		Latch by knob either side except when outside is locked by stopbutton; Then by key outside, turn piece inside. Auxiliary latch deadlocks latch.	06	STORE AND COMMUNICATING		Latch bolt by knob either side. Continuous turn of key retracts both dead bolt and latch bolt either side.
02	HOTEL/MOTEL GUEST-ROOM		Latch bolt by knob inside only, outside knob rigid at all times. Latch bolt and dead bolt by key outside, dead bolt by turn knob inside which shuts out all key except the emergency. Dead bolt deadlocks latch bolt and projects indicating pin outside. Turning of outside knob simultaneously retracts dead bolt and latch bolt.	07	PASSAGE		For doors that do not require locking. Either knob operates the latch bolt all time.
03	CORRIDOR AND OFFICE		Latch bolt by knob from either side, except when outside knob is locked by stop in front, then by key outside and knob inside. Auxiliary latch deadlocks latch bolt.	08	PRIVACY		Latch bolt by knob either side. Dead bolt by turn piece inside. Insert a screwdriver or flat narrow tool in access hole and rotate to unlock from outside. Inside knob retracts latch and deadbolt simultaneously.
04	STOREROOM		Latch bolt by knob inside and key outside. Outside knob is always rigid and inside knob is always free for exit. Auxiliary latch deadlocks latch bolt.	16	DEADLOCK (SINGLE CYLINDER)		Dead bolt by key on either side.
05	ENTRANCE AND STOREROOM		Latch bolt by knob either side. Deadbolt by turn piece inside. Continuous turn of key retracts both dead bolt and latch bolt outside.	17	DEADLOCK (DOUBLE CYLINDER)		Dead bolt by key outside and turn piece inside.
05B	DORMITORY		Latch by knob on either side except when project deadbolt locks outside knob and deadlocks latch. Deadbolt and latch by key outside. Deadbolt by turn piece inside. Inside knob retracts latch and deadbolt simultaneously, automatically unlocking outside knob. Auxiliary latch deadlocks, latch.				

DL SERIES



HEAVY DUTY US MORTISE LOCK

美式重型插芯門鎖



7



Specification 規格

ANSI STANDARD 美國標準	UL approval for fire test 3 hours 通過美國聯邦實驗三小時燃燒測試
FINISH AVAILABLE 顏色供應:	US3, US4, US5, US15A, US26, US26D 金、沙金、青古、古銀、光粉、沙粉
DEADBOLT 輔助鎖:	1" (25mm) throw 2 pcs. hardened steel rod 一吋 (25毫米) 實芯鋼製高質輔助鎖芯兩支高硬鋼柱杆
LATCH BOLT 緩衝鎖舌:	Standard 3/4" (18mm) x 1" (25mm) extension throw 標準3/4吋 x 1吋
LATCH BACKSET 緩衝鎖舌孔中:	2-3/8" (60mm), 2-3/4" (70mm), 3-5/8" (90mm) 2-3/8吋 x 2-3/4吋 x 3-5/8吋
LATCH FACE PLATE 緩衝鎖舌面板:	Square cornered 1-3/8" (32mm) x 8-1/4" (204mm) 正方形角 1-3/8吋 x 8-1/4吋
STRIKE 鎖口舌:	Half lip strike 1-7/8" (47mm) x 4-3/4" (119mm) 半唇式 1-7/8吋 x 4-3/4吋
CYLINDER AND KEYS 鎖筒鎖匙:	M-Solid Brass Dimple cylinder with 3 nickel plated keys M-銅製電鍍匙鎖筒連三鑰匙 N-Solid Brass traditional cylinder with 3 nickel plated keys N-傳統型五珠鎖筒連三鑰匙
HANDING 把手方向:	Left / Right hand 左 / 右
DOOR THICKNESS 門厚:	Standard: 1-5/8" (38mm) to 2" (51mm) Option: 2" (51mm) to 2-3/8" (61mm) specify when order 標準型: 1-5/8吋至2吋 特別制: 2吋至2-3/8吋 (訂貨特別注明)

DF SERIES



MP-DF04-6401-US15



MP-DF06-6401-US5

HEAVY DUTY US MORTISE LOCK



8



美式重型插芯門鎖

美式插芯/鎖膽尺碼配對表

B	C A		35mm	38mm	40mm	42mm	45mm	51mm	57mm	61mm
	DM	8mm	25mm	25mm	29mm	29mm	29mm	32mm	35mm	38mm
DA	10mm	25mm	29mm	29mm	32mm	32mm	35mm	38mm	38mm	
DL	19mm	25mm	38mm	38mm	40mm	42mm	45mm	45mm		
DB	2.3mm	25mm	25mm	29mm	29mm	29mm	32mm	35mm	38mm	
DF	2.3mm	25mm	25mm	29mm	29mm	29mm	32mm	35mm	38mm	

DOOR THICKNESS LOCK TRIM THICKNESS

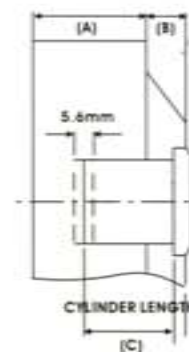

DF SERIES



MP-DF01-6401-US3

MP-DF02-6401-US15

MP-DF03-6401-US3